

STANDARD F COVID-19 Ag FIA

STANDARD F COVID-19 Ag FIA is the fluorescent immunoassay for the qualitative detection of specific nucleoprotein antigens to SARS-CoV-2 present in human nasopharynx.

- **Test time:** Within 15 mins.
- **Specimen:** Nasopharyngeal swab
- **Storage Temperature:** 2-30°C/36-86°F
- **Result Analyzer:** F 200 / F 2400
- **Pack size:** 25 test/kit
- **Flourescent Immunoassay (Euporium)Method**



Benefits

- Excellent sensitivity and speciifiicity with Flourescent
- Easy-to-use
- Fast results within 15 minutes
- More than 4 times higher sensitivity than RDTs¹
- Room temperature storage
- Ready-to use reagents
- Requires an analyzer

Advantage of Antigen Test

- Flourescent Immunoassay (Euporium) Method
- Providing additional information through Cut-off index
- Convenient data management via LIS/HIS connectivity
- Ready-to-use and room temperature storage condition

Standard F200 Analyzer
STANDARD F200 provide LIS connectivity to connect the majority of existing information system in hospital. So it is good to use in hospital, clinic or small to medium size lab.



Standard F2400 Analyzer
STANDARD F2400 have been designed for easy and reliable measuring of diverse items STANDARD F2400 provide LIS connectivity to connect the majority of existing information system in hospital. So it is good to use in hospital, clinic or small to medium size lab.



Specification	F200 Analyzer	F2400 Analyzer
Memory	Save 3,000 measurement of result	5,000 (Run Test)
Connectivity	Direct LIS/HIS, HL7 v2.6, POCT1-A	Direct LIS/HIS, HL7 v2.6 (PCD-01), POCT1-A
Display	10" Color Touch Screen	10" Color Touch Screen
Printer	Built-in	Built-in
Battery	AC/DC adapter	AC/DC adapter
Size	200 x 240 x 205 mm	510 x 566 x 297 mm
Weight	2.5kg	20kg

STANDARD TEST MODE - For the single patient sample

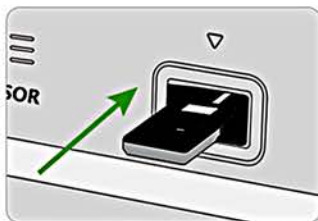

1 Insert the test device to the test slot of the analyzer.



2 Apply 4 drops of extracted specimen

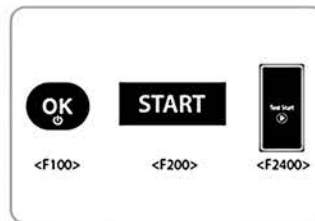

3 Press the "TEST START"



4 Result in 15 mins.

READ ONLY MODE - For the several patient sample

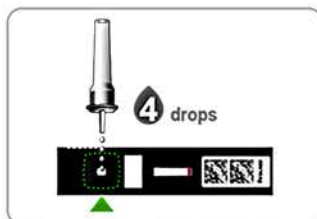

1 Apply 4 drops of extracted specimen.



2 Incubate for 15 mins.

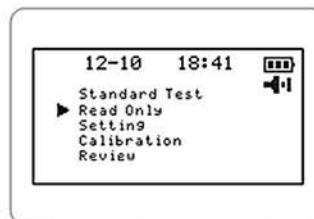

3 Set the analyzer to the READ ONLY Mode.

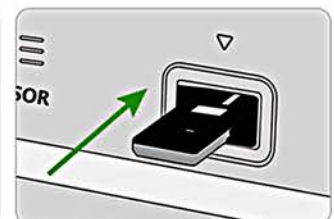

4 READ the test result.